

THE SHORES AT LAKE DE SMET MARKETING EXHIBIT

LOCATED IN SECTIONS 19 AND 20, T52N, R82W, 6TH. P.M.
JOHNSON COUNTY, WYOMING

The Shores
at
Lake DeSmet



A Recreational Waterfront Community
www.lakedesmet.com

LEGEND	
	PHASE I
	COMMON AREA
	FUTURE OFFERINGS
PKY	STREET ADDRESS NUMBER
Lot X	LAND DESCRIPTION
X	Acres

Disclaimer:
This exhibit is to be used as a visual aid. The information is not guaranteed by Centennial Collaborative OR the sellers.

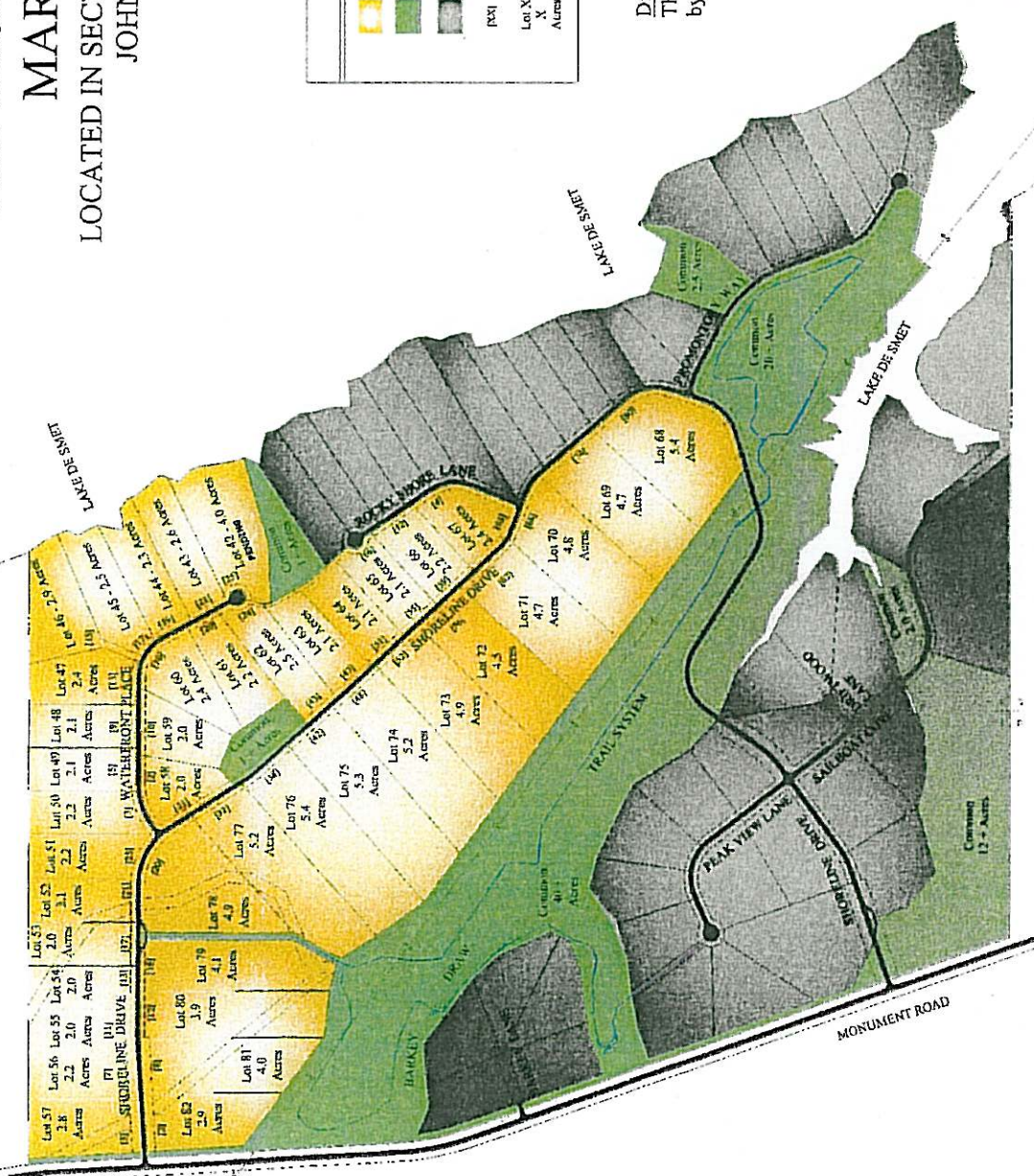
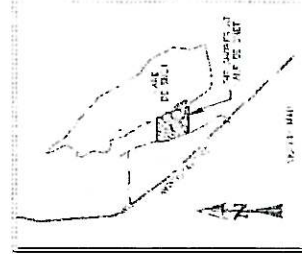

ARCHITECTS • ENGINEERS • SURVEYORS
237 North Mann St. - Sheridan, WY 82801 - (307) 672-1711
400 South Miller Ave. - Chelette, WY 82716 - (307) 682-1141
141 Smith Center, #415 - Casper, WY 82401 - (307) 473-8030

**SHORES AT LAKE DESMET
PHASE 1 - EARLY INVESTORS & COMMUNITY MEMBERS**

LOT #	ACRES	2008 PRICE LIST	EARLY CONSTRUCTION PRICES (expires 5-16-08)	PRICE REDUCTION (expires 5-16-08)	DISTINGUISHING CHARACTERISTICS	STATUS
42	4	\$295,000	\$295,000	\$0	Lake Frontage	PENDING
43	2.6	\$215,000	\$175,000	\$40,000	Lake Frontage	AVAILABLE
44	2.3	\$210,000	\$165,000	\$45,000	Lake Frontage	AVAILABLE
45	2.5	\$210,000	\$165,000	\$45,000	Lake Frontage	AVAILABLE
46	2.9	\$215,000	\$215,000	\$0	Lake Frontage	AVAILABLE
47	2.4	\$145,000	\$101,500	\$43,500	Lake Views	AVAILABLE
48	2.1	\$127,000	\$88,900	\$38,100	Lake Views	AVAILABLE
49	2.1	\$127,000	\$88,900	\$38,100	Lake Views	AVAILABLE
50	2.2	\$133,000	\$93,100	\$39,900	Lake Views	AVAILABLE
51	2.2	\$125,000	\$87,500	\$37,500	Lake Views / Mountain Views	AVAILABLE
52	2.1	\$125,000	\$87,500	\$37,500	Lake Views / Mountain Views	AVAILABLE
53	2	\$82,000	\$76,000	\$6,000	Mountain Views	AVAILABLE
54	2	\$85,000	\$76,000	\$19,000	Mountain Views	AVAILABLE
55	2	\$92,000	\$76,000	\$16,000	Mountain Views	AVAILABLE
56	2.2	\$88,000	\$76,000	\$10,000	Mountain Views	AVAILABLE
57	2.8	\$82,000	\$76,000	\$6,000	Mountain Views	AVAILABLE
58	2	\$128,000	\$89,600	\$38,400	Lake Views	AVAILABLE
59	2	\$128,000	\$89,600	\$38,400	Lake Views	AVAILABLE
60	2.4	\$150,000	\$105,000	\$45,000	Lake View/Mountain View	AVAILABLE
61	2.2	\$137,000	\$95,900	\$41,100	Lake Views	AVAILABLE
62	2.6	\$156,000	\$109,200	\$46,800	Lake Views & Mountain Views	AVAILABLE
63	2.1	\$131,000	\$91,700	\$39,300	Lake Views & Mountain Views	AVAILABLE
64	2.1	\$131,000	\$91,700	\$39,300	Lake Views & Mountain Views	AVAILABLE
65	2.1	\$131,000	\$91,700	\$39,300	Lake Views & Mountain Views	AVAILABLE
66	2.2	\$141,000	\$99,700	\$42,300	Lake Views & Mountain Views	AVAILABLE
67	2.4	\$142,000	\$99,400	\$42,600	Lake Views & Mountain Views	AVAILABLE
68	5.4	\$180,000	\$126,000	\$54,000	Lake Views & Mountain Views	AVAILABLE
69	4.7	\$180,000	\$133,000	\$57,000	Lake Views & Mountain Views	AVAILABLE
70	4.8	\$180,000	\$133,000	\$57,000	Lake Views & Mountain Views	AVAILABLE
71	4.7	\$180,000	\$128,000	\$54,000	Lake Views & Mountain Views	AVAILABLE
72	4.5	\$158,000	\$110,600	\$47,400	Lake Views & Mountain Views	AVAILABLE
73	4.6	\$158,000	\$110,600	\$47,400	Mountain Views	AVAILABLE
74	5.2	\$158,000	\$110,600	\$47,400	Mountain Views	AVAILABLE
75	5.3	\$158,000	\$110,600	\$47,400	Mountain Views	AVAILABLE
76	5.4	\$182,000	\$113,400	\$48,600	Mountain Views	AVAILABLE
77	5.2	\$182,000	\$113,400	\$48,600	Mountain Views	AVAILABLE
78	4.9	\$152,000	\$108,400	\$45,600	Mountain Views	AVAILABLE
79	4.1	\$118,000	\$82,600	\$35,400	Mountain Views	AVAILABLE
80	3.9	\$117,000	\$81,900	\$35,100	Mountain Views	AVAILABLE
81	4	\$102,000	\$76,000	\$26,000	Mountain Views	AVAILABLE
82	2.9	\$83,000	\$76,000	\$17,000	Mountain Views	AVAILABLE

THE SHORES AT LAKE DESMET

Don't miss this opportunity! The Developer is offering a substantial discount on lots purchased before May 16, 2008. This lake shore community offers premium residential lots with lake frontage and mountain views, paved streets, natural gas, underground utilities and a community water system. Acres of green space available for owners' use and recreation.

Excellent opportunity to build a home conveniently located between Buffalo and Sheridan. 2 - 5 acre lots prices start at \$76,000.00. Contractors welcome!